

DU Thrust Washer, Standard Metric Sizes List

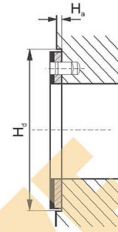
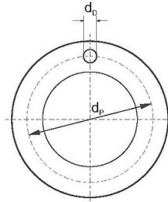
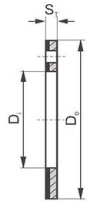

SINOBRONZE

Unit:mm

Shaft D _s	Designation	Washer dimension				Installation size		H _s +0.12
		D +0.25	D ₁ -0.25	S ₁ -0.05	d ₀ ± 0.125	d ₁ +0.4 d ₁ -0.1	H ₁ ± 0.2	
8	WC08DU	10	20	1.5	15	1.5	1	20
10	WC10DU	12	24		18			24
12	WC12DU	14	26		20			26
14	WC14DU	16	30		23	30		
16	WC16DU	18	32		25			
18	WC18DU	20	36		28	32		
20	WC20DU	22	38		30			
22	WC22DU	24	42		33	42		
24	WC24DU	26	44		35			
26	WC26DU	28	48		38	48		
30	WC30DU	32	54	43				
36	WC36DU	38	62	50	62			
40	WC40DU	42	66	54				
46	WC46DU	48	74	61	74			
50	WC50DU	52	78	65				
60	WC60DU	62	90	76	2	1.5	90	

DU Strip / Plate, Standard Metric Sizes List



SINOBRONZE

Unit:mm

Type	Length ± 1	Width ± 1	Thickness -0.05
S10150DU	500	150	1.0
S15150DU	500	150	1.5
S20150DU	500	150	2.0
S25150DU	500	150	2.5

DU Thrust Washer, Standard Inch Sizes List



SINOBRONZE

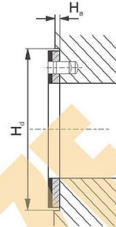
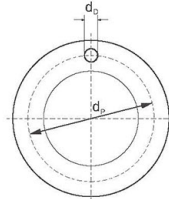
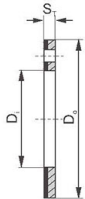

Unit: inch^o

Designation	Washer dimension				Installation size			
	Inner side D+0.010	Outside D _o -0.010	S ₁	d _o -0.01	d _o +0.010	H ₁ ±0.010	H ₂ +0.010	
DU06	0.500	0.875	0.0630	0.692	0.067	0.04	0.875	
DU07	0.562	1.000		0.786			1.000	
DU08	0.625	1.125		0.880			1.125	
DU09	0.687	1.187		0.942			1.187	
DU10	0.750	1.250		1.005	0.099		1.250	
DU11	0.812	1.375		1.099			1.375	
DU12	0.875	1.500		1.192			1.500	
DU13	0.937	1.625		0.0610	1.286		0.130	1.625
DU14	1.000	1.750			1.380			1.750
DU16	1.125	2.000		0.0930	1.567		0.161	2.000
DU18	1.250	2.125			1.692			2.125
DU20	1.375	2.250			1.817		2.250	
DU22	1.500	2.500			2.005		0.192	2.500
DU24	1.625	2.625			2.130			2.625
DU26	1.750	2.750	2.255		2.750			
DU28	2.000	3.000	2.505		0.07	3.000		
DU30	2.125	3.125	2.630			3.125		
DU32	2.250	3.250	0.0910			2.755	3.250	