

DU-B Flanged Bush, Standard Metric Sizes List

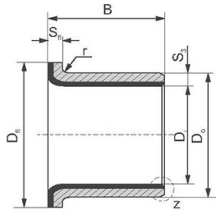

S ₃	1.0	1.5	2.0	2.5
r	1 st	1±0.5	1.5±0.5	2±0.5

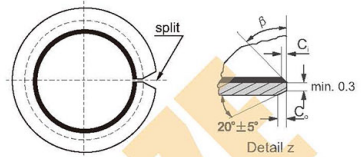

Unit:mm

Shaft D _s	Housing H7 D _h	OD tolerance D _o	ID after fixed D _{is}	Clearance C _o	Designation	Wall thickness S ₃	Dimension					
							D	D _c	D _o ± 0.5	B ± 0.25	S ₃ -0.2	
6 -0.013 -0.028	8 +0.015	8 +0.055 +0.025	6.055 5.990	0.077 0.000	BB0604DUB	1.005 0.980	6	8	12	4	1	
					BB0607DUB							5
8 -0.013 -0.028	10 +0.015	10 +0.055 +0.025	8.055 7.990	0.083 0.003	BB08055DUB	1.005 0.980	8	10	15	5.5	1	
					BB08075DUB							7.5
10 -0.016 -0.034	12 +0.018	12 +0.055 +0.025	10.058 9.990	0.086 0.003	BB1007DUB	1.005 0.980	10	12	18	7	1	
					BB1009DUB							9
					BB1012DUB							12
12 -0.016 -0.034	14 +0.018	14 +0.065 +0.030	12.058 11.990	0.092 0.006	BB1207DUB	1.005 0.980	12	14	20	7	1	
					BB1209DUB							9
					BB1212DUB							12
					BB1412DUB							12
14 -0.016 -0.034	16 +0.018	16 +0.065 +0.030	14.058 13.990	0.092 0.006	BB1417DUB	1.005 0.980	14	16	22	17	1	
					BB1509DUB							9
					BB1517DUB							17
15 -0.016 -0.034	17 +0.018	17 +0.065 +0.030	15.058 14.990	0.095 0.006	BB1512DUB	1.005 0.980	15	17	23	12	1.5	
					BB1517DUB							17
16 -0.016 -0.034	18 +0.018	18 +0.065 +0.030	16.058 15.990	0.095 0.006	BB1612DUB	1.005 0.980	16	18	24	12	1.5	
					BB1617DUB							17
18 -0.016 -0.034	20 +0.021	20 +0.075 +0.035	18.061 17.990	0.095 0.006	BB1812DUB	1.005 0.980	18	20	26	12	1.5	
					BB1817DUB							17
					BB1820DUB							20
20 -0.020 -0.041	23 +0.021	23 +0.075 +0.035	20.071 19.990	0.112 0.010	BB20115DUB	1.505 1.475	20	23	30	11.5	1.5	
					BB20165DUB							16.5
					BB20215DUB							21.5
22 -0.020 -0.041	25 +0.021	25 +0.075 +0.035	22.071 21.990	0.112 0.010	BB2215DUB	1.505 1.475	22	25	32	15	1.5	
					BB2220DUB							20
25 -0.020 -0.041	28 +0.021	28 +0.075 +0.035	25.071 24.990	0.126 0.010	BB25115DUB	2.005 1.970	25	28	35	11.5	2	
					BB25165DUB							16.5
					BB25215DUB							21.5
30 -0.025 -0.050	34 +0.025	34 +0.075 +0.035	30.085 29.990	0.135 0.015	BB3016DUB	2.005 1.970	30	34	42	16	2	
					BB3026DUB							26
35 -0.025 -0.050	39 +0.025	39 +0.085 +0.045	35.085 34.990	0.135 0.015	BB3516DUB	2.005 1.970	35	39	47	16	2	
					BB3526DUB							26
40 -0.025 -0.050	44 +0.025	44 +0.085 +0.045	40.085 39.990	0.135 0.015	BB4026DUB	2.005 1.970	40	44	53	26	2	
					BB4040DUB							40