

SB-DIN9834 ISO9448 Oilless Guide Bushing 欧系标准汽车冲压模具导套

The Standard Identical with: VW/AUDI 39D90 CPEL U2802-95 BMW B2 293312082 70

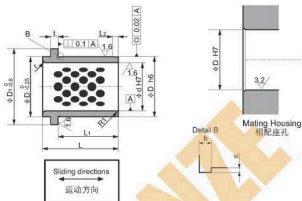

Material Specifications 材料

材料: 高力黄铜+固体润滑剂
CuZr25Al5Mn4Fe3+Graphite(500#SF)

How To Order 订单方式

Code d
● SB-SOST 025

Unit(单位): mm

SinoBronze Standard No.	d H7	D h6	L	D ₁	L ₁	L ₂	t	r	bxc	P	
● SB-DIN9834-025	25	+0.021 0	32	40	40	30	3	6.3	3	0.6 × 0.3	58
SB-DIN9834-032	32	40	50	50	40	4	66				
SB-DIN9834-040	40	+0.025 0	50	63	63	50	5				79
SB-DIN9834-050	50	63	0	71	71	56	6.3	5	89		
SB-DIN9834-063	63	80	0	90	90	63	8	6	123		
SB-DIN9834-080	80	+0.030 0	100	0	100	112	80	10	8	143	
SB-DIN9834-100	100	125	0	125	140	106	12.5	10	10	1.0 × 0.4	168
SB-DIN9834-125	125	+0.040 0	160	0	160	180	132	16	12	203	
SB-DIN9834-160	160	200	0	200	220	170	16	18	18	243	

Clamp VDI-KL (DIN9834 ISO9448) 压板

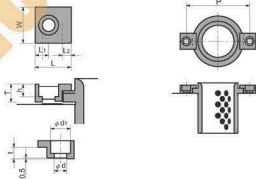

Material Specifications 材料

材料: 钢 C45
Material: Steel C45
Clamp ident. with DIN 9832

How To Order 订单方式

Code t
● VDI-KL 6

SinoBronze Standard No.	W	L	T	L ₁	L ₂	t	d	d ₁	h	Applicable bushes ID 适用的铅套内孔尺寸
● VDI-KL-6	20	20	10	7.5	5	6.3	7	11	7	φ25-φ50
VDI-KL-10	32	32	16	11	10	10	11.5	17.5	11.5	φ63-φ160