

DX Cylindrical Bush, Standard Inch Sizes List

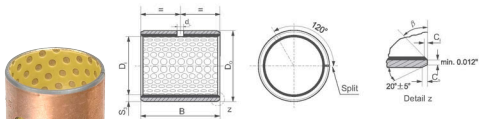

SINOBRONZE

ID and OD chamfers

S ₁	C ₀	C ₁	β	S ₂	C ₀	C ₁	β
0.0505	0.012-0.035	0.004-0.020	30° ±5°	0.0971	0.047-0.095	0.020-0.043	45° ±5°
0.0663	0.016-0.040	0.005-0.030	30° ±5°	0.0978	0.047-0.095	0.020-0.043	45° ±5°
0.0817	0.030-0.063	0.005-0.030	30° ±5°				

Unit:inch"

D ₁	D ₀	Shaft D _s	Housing H7 D _h	ID after fixed D _{1s}	Clearance C _p	Wall thickness S ₁	Oil hole d ₁	Length ±0.010				
3/8	15/32	0.3648 0.3639	0.4694 0.4687	0.3694 0.3667	0.0055 0.0019	0.0090 0.0500	5/32	06DX06	06DX08	06DX12		
7/16	17/32	0.4273 0.4263	0.5319 0.5312	0.4319 0.4292	0.0056 0.0019			07DX06	07DX12			
1/2	19/32	0.4897 0.4887	0.5944 0.5937	0.4944 0.4917	0.0057 0.0020			08DX06	08DX08	08DX10	08DX14	
9/16	21/32	0.5522 0.5512	0.6569 0.6562	0.5569 0.5542	0.0057 0.0020			09DX06	09DX12			
5/8	23/32	0.6146 0.6136	0.7195 0.7178	0.6195 0.6167	0.0059 0.0021			10DX08	10DX10	10DX12	10DX14	
11/16	25/32	0.6770 0.6760	0.7820 0.7812	0.6820 0.6792	0.0060 0.0022			11DX14				
3/4	7/8	0.7390 0.7378	0.8758 0.8750	0.7444 0.7412	0.0066 0.0022			12DX08	12DX12	12DX16		
7/8	1	0.8639 0.8627	1.0008 1.0000	0.8694 0.8662	0.0067 0.0023			14DX12	14DX14	14DX16		
1	1 1/8	0.9898 0.9876	1.1258 1.1250	0.9944 0.9912	0.0068 0.0024			16DX12	16DX16	16DX24		
1 1/8	1 9/32	1.1138 1.1126	1.2822 1.2812	1.1202 1.1164	0.0076 0.0026			18DX12	18DX16			
1 1/4	1 13/32	1.2387 1.2371	1.4072 1.4062	1.2452 1.2414	0.0081 0.0027			20DX12	20DX16	20DX20	20DX28	
1 3/8	1 17/32	1.3635 1.3619	1.5312 1.5312	1.3702 1.3664	0.0083 0.0029			22DX16	22DX22	22DX28		
1 1/2	1 21/32	1.4884 1.4868	1.6572 1.6562	1.4952 1.4914	0.0084 0.0030	24DX16	24DX20	24DX24				
1 5/8	1 25/32	1.6133 1.6117	1.7822 1.7812	1.6202 1.6164	0.0085 0.0031	26DX16	26DX24		24DX32			
1 3/4	1 15/16	1.7383 1.7367	1.9385 1.9375	1.7461 1.7415	0.0094 0.0032	28DX16	28DX24	28DX28				
1 7/8	2 1/16	1.8632 1.8616	2.0637 2.0625	1.8713 1.8665	0.0097 0.0033	30DX16	30DX30	30DX36	28DX32			
2	2 3/16	1.9881 1.9863	2.1887 2.1875	1.9963 1.9915	0.0100 0.0034	32DX16	32DX24	32DX32				
2 1/4	2 7/16	2.2378 2.2360	2.4387 2.4375	2.2463 2.2415	0.0103 0.0037	36DX32	36DX36	36DX40	32DX40			
2 1/2	2 11/16	2.4875 2.4857	2.6887 2.6875	2.4963 2.4915	0.0106 0.0040	40DX32	40DX40					
2 3/4	2 15/16	2.7351 2.7333	2.9387 2.9375	2.7457 2.7393	0.0124 0.0042	44DX32	44DX40	44DX48				
3	3 3/16	2.9849 2.9831	3.1889 3.1875	2.9959 2.9893	0.0128 0.0044	48DX32	48DX48	48DX60				
3 1/2	3 11/16	3.4844 3.4822	3.6889 3.6875	3.4959 3.4893	0.0137 0.0049	56DX40	56DX48	56DX60	44DX56			
4	4 3/16	3.9839 3.9817	4.1889 4.1875	3.9959 3.9893	0.0142 0.0054	64DX48	64DX60	64DX76				

DX Thrust Washer, Standard Inch Sizes List

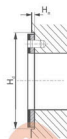
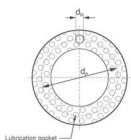

Unit:inch^{*}

Specification	Dimension			installation size			
	inner side $D_1+0.010$	outside $D_2-0.010$	S_1	d_1 -0.010	d_2 $+0.010$	H_1 ± 0.010	H_2 $+0.010$
06DX	0.500	0.875	0.0660 0.0625	0.692	0.099	0.04	0.875
07DX	0.562	1.000		0.786			1.000
08DX	0.625	1.125		0.880			1.125
09DX	0.687	1.187		0.942			1.187
10DX	0.750	1.250		1.005			1.250
11DX	0.812	1.375		1.099			1.375
12DX	0.875	1.500		1.192	1.500		
13DX	0.937	1.625		1.286	1.625		
14DX	1.000	1.750		1.380	1.750		
16DX	1.125	2.000		1.567	2.000		
18DX	1.250	2.125		1.692	2.125		
20DX	1.375	2.250		1.817	2.250		
22DX	1.500	2.500		2.005	2.500		
24DX	1.625	2.625		2.130	2.625		
26DX	1.750	2.750		2.255	2.750		
28DX	2.000	3.000		2.505	3.000		
30DX	2.125	3.125	2.630	3.125			
32DX	2.250	3.250	2.755	3.250			