

HX Cylindrical Bushes, Standard Metric Sizes List

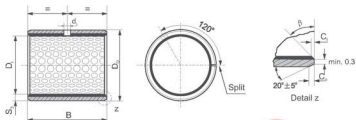

SINOBRONZE



ID and OD chamfers

S ₁	C ₀	C	β	S ₁	C ₀	C	β
1.0	0.6±0.3	0.30±0.2	30° ±5°	2.0	1.2±0.4	0.50±0.3	30° ±5°
1.5	0.7±0.3	0.50±0.2	30° ±5°	2.5	1.8±0.6	0.80±0.3	45° ±5°

Unit:mm

Shaft D _s h8	Housing H7 D _h	OD tolerance D ₀	ID after fixed D _{1s}	Clearance C ₀	Wall thickness S ₁	Oil hole d ₁	B ⁰ _{-0.40}														
							10	15	20	25	30	35	40	45	50	60					
10 ^{+0.022} _{-0.022}	12 ^{+0.018} _{-0.018}	12 ^{+0.065} _{-0.030}	10.108 10.040	0.130 0.040	0.980 0.955	4	1010HX	1015HX	1020HX												
12 ^{+0.027} _{-0.027}	14 ^{+0.018} _{-0.018}	14 ^{+0.065} _{-0.030}	12.108 12.040				1210HX	1215HX	1220HX												
14 ^{+0.027} _{-0.027}	16 ^{+0.018} _{-0.018}	16 ^{+0.065} _{-0.030}	14.108 14.040	0.135 0.040	0.980 0.955		1413HX	1420HX													
15 ^{+0.027} _{-0.027}	17 ^{+0.018} _{-0.018}	17 ^{+0.065} _{-0.030}	15.108 15.040				1515HX	1520HX	1525HX												
16 ^{+0.027} _{-0.027}	18 ^{+0.018} _{-0.018}	18 ^{+0.065} _{-0.030}	16.108 16.040	0.138 0.040	0.980 0.955		1615HX	1620HX	1625HX												
18 ^{+0.027} _{-0.027}	20 ^{+0.021} _{-0.021}	20 ^{+0.075} _{-0.035}	18.111 18.040				1815HX	1820HX	1825HX												
20 ^{+0.033} _{-0.033}	23 ^{+0.021} _{-0.021}	23 ^{+0.075} _{-0.035}	20.131 20.050	0.164 0.050	1.475 1.445		2015HX	2020HX	2025HX	2030HX											
22 ^{+0.033} _{-0.033}	25 ^{+0.021} _{-0.021}	25 ^{+0.075} _{-0.035}	22.131 22.050				2215HX	2225HX													
25 ^{+0.033} _{-0.033}	28 ^{+0.021} _{-0.021}	28 ^{+0.075} _{-0.035}	25.131 25.050	0.188 0.060	1.970 1.935		2515HX	2520HX	2525HX	2530HX											
28 ^{+0.033} _{-0.033}	32 ^{+0.025} _{-0.025}	32 ^{+0.085} _{-0.045}	28.155 28.060				2820HX	2830HX													
30 ^{+0.033} _{-0.033}	34 ^{+0.025} _{-0.025}	34 ^{+0.085} _{-0.045}	30.155 30.060	0.194 0.060	1.970 1.935	3030HX	3025HX	3030HX	3040HX												
35 ^{+0.039} _{-0.039}	39 ^{+0.025} _{-0.025}	39 ^{+0.085} _{-0.045}	35.155 35.060			3520HX	3530HX	3535HX	3540HX												
40 ^{+0.039} _{-0.039}	44 ^{+0.025} _{-0.025}	44 ^{+0.085} _{-0.045}	40.155 40.060	0.234 0.080	2.460 2.415	4020HX	4030HX	4040HX	4040HX	4050HX											
45 ^{+0.039} _{-0.039}	50 ^{+0.025} _{-0.025}	50 ^{+0.085} _{-0.045}	45.195 45.080			4520HX	4530HX	4540HX	4545HX	4550HX											
50 ^{+0.039} _{-0.039}	55 ^{+0.030} _{-0.030}	55 ^{+0.100} _{-0.055}	50.200 50.080	0.239 0.080	2.460 2.415	5030HX	5040HX	5040HX	5050HX	5060HX											
55 ^{+0.046} _{-0.046}	60 ^{+0.030} _{-0.030}	60 ^{+0.100} _{-0.055}	55.200 55.080			5530HX	5540HX	5550HX	5560HX												
60 ^{+0.046} _{-0.046}	65 ^{+0.030} _{-0.030}	65 ^{+0.100} _{-0.055}	60.200 60.080	0.246 0.080		6030HX	6040HX	6050HX	6060HX												

HX Cylindrical Bushes, Standard Metric Sizes List

Unit:mm

Shaft D _s h8	Housing H7 D _h	OD tolerance D ₀	ID after fixed D ₁	Clearance C ₀	Wall thickness S ₁	Oil hole d _o	B ⁰ _{-0.40}															
							40	50	60	80	90	95	100	110	120							
65 ^{+0.048} _{-0.048}	70 ^{+0.030}	70 ^{+0.100} _{+0.055}	65.200 65.000	0.245 0.080	2.460 2.415	8	654HX	656HX														
70 ^{+0.048} _{-0.048}	75 ^{+0.030}	75 ^{+0.100} _{+0.055}	70.200 70.000				704HX	705HX		706HX												
75 ^{+0.048} _{-0.048}	80 ^{+0.030}	80 ^{+0.100} _{+0.055}	75.200 75.000				754HX	756HX	756HX													
80 ^{+0.048} _{-0.048}	85 ^{+0.035}	85 ^{+0.120} _{+0.070}	80.265 80.100	0.313 0.100	2.450 2.385	9.5	804HX	806HX	806HX													
85 ^{+0.054} _{-0.054}	90 ^{+0.035}	90 ^{+0.120} _{+0.070}	85.265 85.100				854HX	856HX	856HX													
90 ^{+0.054} _{-0.054}	95 ^{+0.035}	95 ^{+0.120} _{+0.070}	90.265 90.100				904HX	906HX	906HX	908HX												
100 ^{+0.054} _{-0.054}	105 ^{+0.035}	105 ^{+0.120} _{+0.070}	100.265 100.100	0.321 0.100	2.450 2.385	9.5	1005HX	1006HX	1006HX	1008HX												
105 ^{+0.054} _{-0.054}	110 ^{+0.035}	110 ^{+0.120} _{+0.070}	105.265 105.110				1055HX	1056HX	1056HX	1058HX	10510HX											
110 ^{+0.054} _{-0.054}	115 ^{+0.035}	115 ^{+0.120} _{+0.070}	110.265 110.110				1105HX	1106HX	1106HX	1108HX	11010HX											
120 ^{+0.063} _{-0.063}	125 ^{+0.040}	125 ^{+0.170} _{+0.100}	120.270 120.110	0.324 0.110	2.450 2.385	9.5	1205HX	1206HX	1206HX					12010HX								
125 ^{+0.063} _{-0.063}	130 ^{+0.040}	130 ^{+0.170} _{+0.100}	125.270 125.110				1255HX	1256HX	1256HX							12510HX						
130 ^{+0.063} _{-0.063}	135 ^{+0.040}	135 ^{+0.170} _{+0.100}	130.270 130.110				1305HX	1306HX	1306HX							13010HX						
140 ^{+0.063} _{-0.063}	145 ^{+0.040}	145 ^{+0.170} _{+0.100}	140.270 140.110	0.339 0.110	2.450 2.385	9.5	1405HX	1406HX	1406HX	1408HX				14010HX								
150 ^{+0.063} _{-0.063}	155 ^{+0.040}	155 ^{+0.170} _{+0.100}	150.270 150.110				1505HX	1506HX	1506HX							15010HX						
160 ^{+0.063} _{-0.063}	165 ^{+0.040}	165 ^{+0.170} _{+0.100}	160.270 160.110				1605HX	1606HX	1606HX							16010HX						
170 ^{+0.063} _{-0.063}	175 ^{+0.040}	175 ^{+0.170} _{+0.100}	170.270 170.110	0.339 0.110	2.450 2.385	9.5	1705HX	1706HX	1706HX					17010HX								
180 ^{+0.063} _{-0.063}	185 ^{+0.046}	185 ^{+0.210} _{+0.130}	180.276 180.110				1805HX	1806HX	1806HX							18010HX						
190 ^{+0.072} _{-0.072}	195 ^{+0.046}	195 ^{+0.210} _{+0.130}	190.276 190.110				1905HX	1906HX	1906HX							19010HX	190120HX					
200 ^{+0.072} _{-0.072}	205 ^{+0.046}	205 ^{+0.210} _{+0.130}	200.276 200.110	0.354 0.110	2.450 2.385	9.5	2005HX	2006HX	2006HX	2008HX				20010HX	200120HX							
220 ^{+0.072} _{-0.072}	225 ^{+0.046}	225 ^{+0.210} _{+0.130}	220.276 220.110				2205HX	2206HX	2206HX							22010HX	220120HX					
240 ^{+0.072} _{-0.072}	245 ^{+0.046}	245 ^{+0.210} _{+0.130}	240.276 240.110				2405HX	2406HX	2406HX							24010HX	240120HX					
250 ^{+0.072} _{-0.072}	255 ^{+0.052}	255 ^{+0.260} _{+0.170}	250.282 250.110	0.354 0.110	2.450 2.385	9.5	2505HX	2506HX	2506HX	2508HX				25010HX	250120HX							
260 ^{+0.081} _{-0.081}	265 ^{+0.052}	265 ^{+0.260} _{+0.170}	260.282 260.110				2605HX	2606HX	2606HX							26010HX	260120HX					
280 ^{+0.081} _{-0.081}	285 ^{+0.052}	285 ^{+0.260} _{+0.170}	280.282 280.110				2805HX	2806HX	2806HX							28010HX	280120HX					
300 ^{+0.081} _{-0.081}	305 ^{+0.052}	305 ^{+0.260} _{+0.170}	300.282 300.110				3005HX	3006HX	3006HX					30010HX	300120HX							